



JETRICH CANADA LTD: 3270 Orlando Dr., Mississauga, Ontario, L4V 1C6, CANADA

Thank you for purchasing the Chris & Chris Chef series kitchen work station.

With proper assembly, maintenance, and cleaning, your work station will give you many years of service.

NOTE: IF THERE ARE ANY PARTS MISSING; OR THERE IS SLIGHT SHIPPING DAMAGE TO YOUR UNIT, DO NOT RETURN TO THE STORE. PLEASE CONTACT OUR CUSTOMER SERVICE DEPT. FOR HELP, OR VISIT OUR WEBSITE FOR FURTHER INFORMATION.

CUSTOMER SERVICE: TOLL FREE NUMBER: 1-800-569-4201

E-MAIL: CUSTOMERSERVICE@CHRISANDCHRISHOME.COM

WEBSITE: chrisandchrishome.com

ASSEMBLY TIPS: JET3190 (JET3191 OUTDOOR) "PRO STADIUM" WORK STATION"

PLEASE NOTE: IT IS NECESSARY TO TREAT ALL OF THE WOOD TOPS WITH FOOD GRADE MINERAL OIL OR BLOCK OIL FREQUENTLY WHEN NEW.

ON THE TOPS SUITABLE FOR OUTDOOR USE (#JET3191) IT IS NECESSARY TO TREAT WITH OIL BEFORE PLACING OUTDOORS. FAILURE TO DO SO COULD CAUSE THE CUTTING SURFACE TO CRACK OR CHECK. BRING INDOORS WHEN TEMPERATURES DROP BLOW FREEZING

TOOLS NEEDED: PHILLIPS HEAD SCREWDRIVER

- Unpack all parts carefully.
- Cover work surface with soft blanket or similar substance so as not to damage the unit or your work surface.

Step 1

Please handle the leg and shelf pieces with care. There may be sharp edges exposed until after assembly. Turn top assembly (A) upside down on work surface. Attach legs (C) to all 4 corners of the top frame using screws (JA), big allen wrench (RB) and nuts (XA). **Do not tighten at this time.** Now install middle shelf (B) using screws (JA), big allen wrench (RB) and nuts (XA). **Do not tighten at this time.** Now install the bottom shelf (B) using screws (JA) big allen wrench (RB) and nuts (XA). Now tighten all screws and nuts using allen wrench (RB) and Wrench (Q) legs (C)

Install break wheels (BW) to the bottom of the front legs (C) using big wrench (Q) and Wheel (W) to the bottom of the rear legs (C).

Now install drawer handle (H).

Step 2-3

Slide "S" Hooks (K) over towel bar (F) so that the open end of the "S" hooks face out. Then install towel bar (F) into the holes provided on either end of the end grain top. Secure with Screws (JB). Install wood plugs (NP) into the holes on the opposite side of the top.

The chef pan can be replaced by the trash ring (L) when desired, by inserting a standard plastic grocery bag up through the center of the trash ring (L) wrap it around the edge and place over the chef pan supports.

Pull the bottom of the bag down through the opening in the drawer bottom.

Congratulations, your Pro Chef work station is ready for action

CHEF KITCHEN WORK STATION
JET 3190 / JET 3191

ASSEMBLY INSTRUCTION



A. TOP

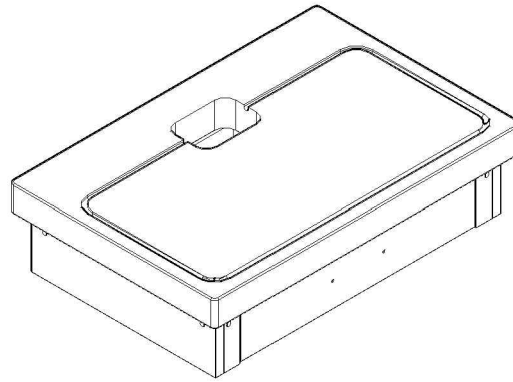

1 EACH

B. SHELF

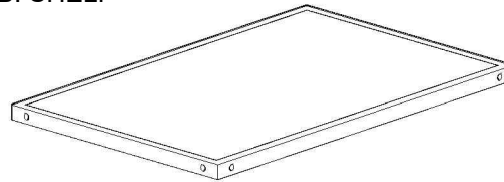

2 EACH

DC. DRAWER BOTTOM COVER

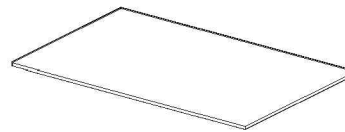

1 EACH

C. LEGS

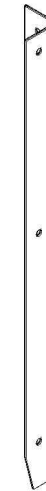

4 EACH

L. TRASH RING



1 EACH

P. CHEF PAN

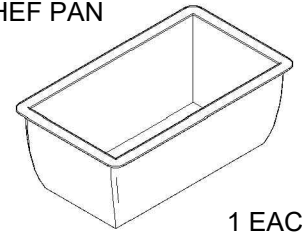

1 EACH

H. HANDLE

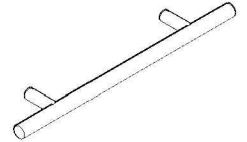

1 EACH

F. TOWER BAR

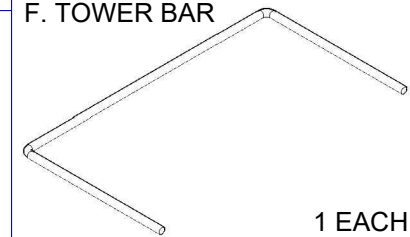

1 EACH

S. SPEED RACK

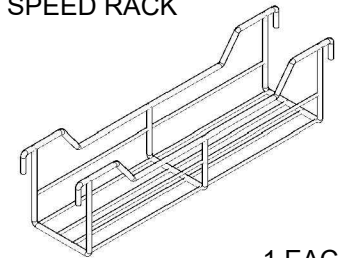

1 EACH

K. "S" HOOK



4 EACH

HARDWARE LIST

BW. BRAKE
WHEEL



2 EACH

W. WHEEL

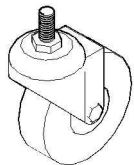

2 EACH

JA. SCREW

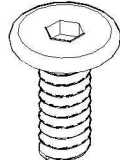

24 EACH

XA. NUT



16 EACH

JB. SCREW

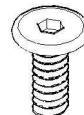

2 EACH

NP. NATURAL
WOOD PLUG



2 EACH

Q. BIG
WRENCH



1 EACH

QS. SMALL
WRENCH



1 EACH

RB. BIG ALLEN
KEY



1 EACH

RM. SMALL
ALLEN KEY



1 EACH

O. OIL



1 EACH

STEP 1

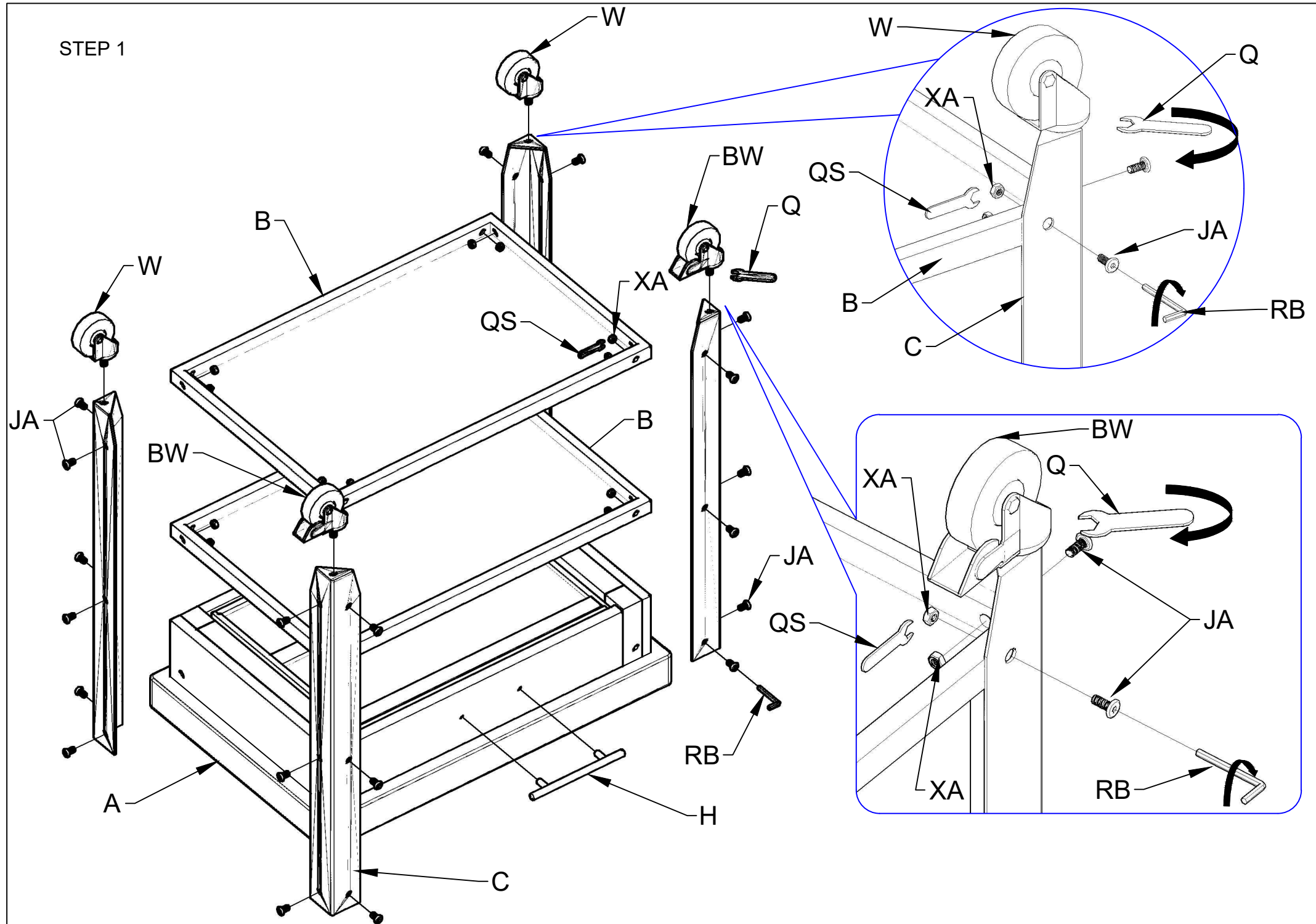

STEP 2

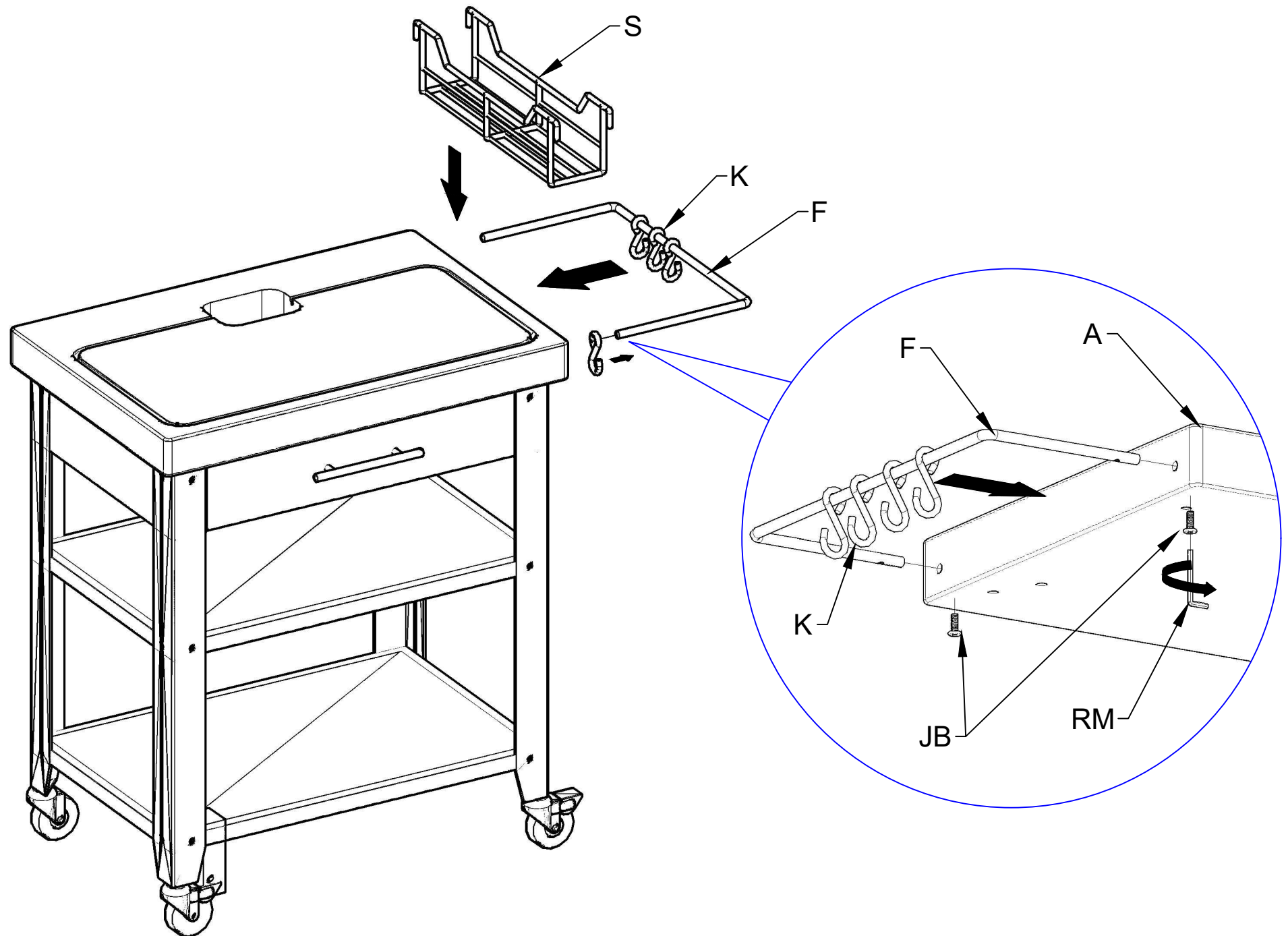

STEP 3

